



# The Oaks

WOODLAND MANOR

Congleton, Cheshire, CW12 1TT



● AVAILABLE  
● SOLD



## Shared Ownership Price List

Plot	House Type	Description	Price	25% Share & Monthly Rent	50% Share & Monthly Rent	75% Share & Monthly Rent
205 208 252 279 281	Dover	3 bedroom end mews	£292,250	£73,063 & £502.30	£146,125 & £334.87	£219,188 & £167.43

Monthly service charge 26/27: £44.91 pcm

**Disclaimer:** Values are reviewed every 3 months and are subject to change. A monthly service charge will apply. Prices, features and availability are correct at time of print but are subject to change without prior notice. Please see your **key information document** before proceeding.

# Dover

909 SQ FT

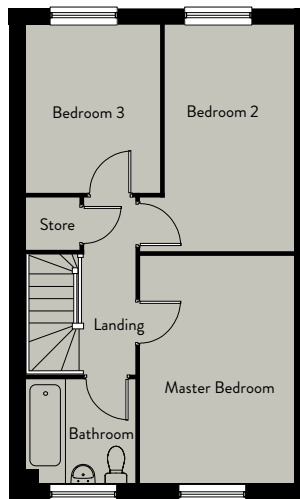
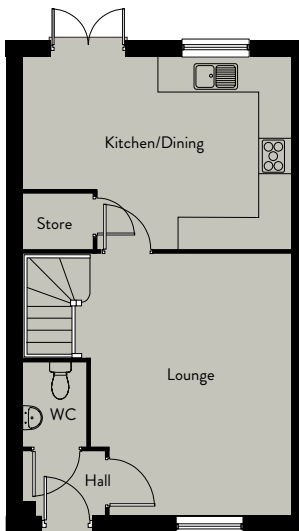

## Ground Floor

Lounge	3.8m x 4.8m	12'4" x 15'11"
Kitchen/Dining	5.0m x 3.6m	16'6" x 11'9"
WC	1.2m x 1.6m	3'10" x 5'3"

## First Floor

Master Bedroom	2.9m x 4.2m	9'7" x 13'11"
Bedroom 2	2.4m x 4.2m	8'0" x 13'9"
Bedroom 3	2.5m x 3.1m	8'3" x 10'2"
Bathroom	2.1m x 1.9m	6'9" x 6'5"