

# Fox Wood Garden Village

Whiston, Merseyside L35 3SS

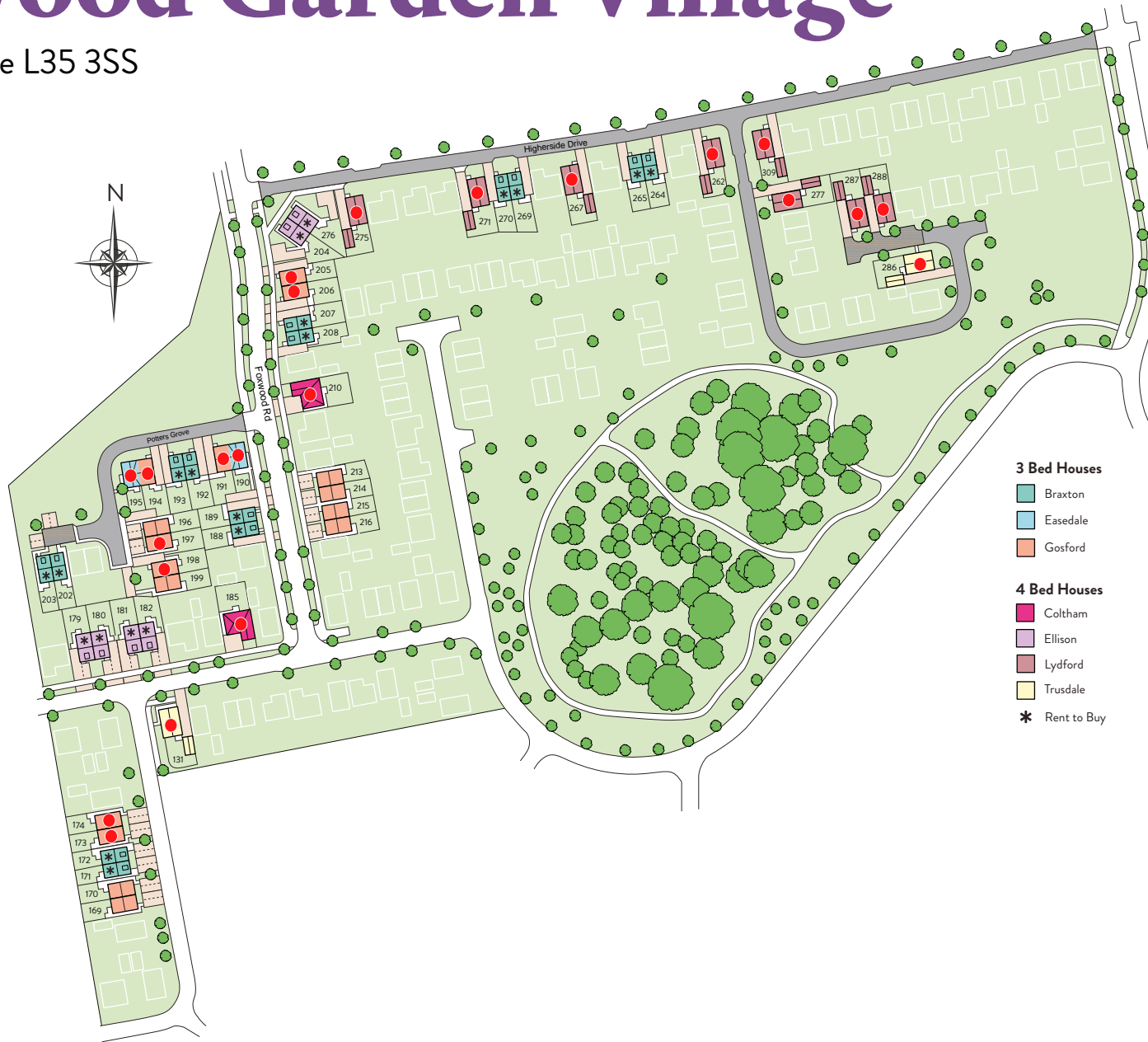

## Foxwood Garden Village Price List

### Shared Ownership

#### Available homes

Plot(s)	Description	House Type	Price	25% Share & Monthly Rent	50% Share & Monthly Rent	75% Share & Monthly Rent
170 196 199 213 214 215 216	3 bedroom semi detached	Gosford	£265,000	£66,250 & £455.47	£132,500 & £303.65	£198,750 & £151.82

*Availability is subject to change and can do so with no prior notice.*

**Disclaimer:** Values are reviewed every 3 months and are subject to change. A monthly service charge will apply to Shared Ownership homes. Prices, features and availability are correct at time of print but are subject to change without prior notice.

Please note, we do not have a site presence. Viewings will be arranged following a successful application and sign-off from our dedicated mortgage broker.

# The Gosford

866 sqft



## Ground Floor

Lounge	3.69m x 4.26m	12'1" x 14'0"
Kitchen/Dining	4.72m x 2.87m	15'6" x 9'5"

## First Floor

Master Bedroom	3.69m x 2.83m	12'1" x 9'4"
Bedroom 2	2.63m x 3.30m	8'8" x 10'10"
Bedroom 3	2.00m x 3.55m	6'7" x 11'8"