

# SANDERLING

1189 SQ FT

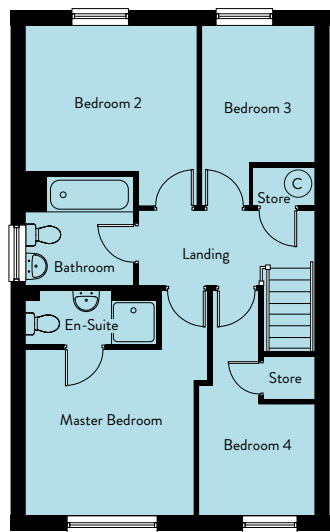
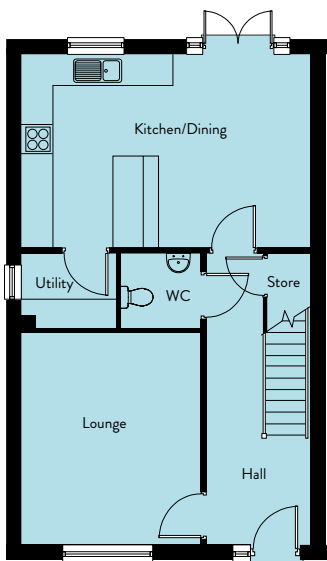

## Ground Floor

Lounge	3.53m x 4.16m	11'7" x 13'8"
Kitchen/Dining	5.68m x 3.79m	18'8" x 12'5"
Utility	1.85m x 1.50m	6'1" x 4'11"
WC	1.59m x 1.50m	5'3" x 4'11"

## First Floor

Master Bedroom	3.34m x 3.26m	10'11" x 10'8"
En-Suite	2.58m x 1.10m	8'5" x 3'7"
Bedroom 2	3.39m x 2.89m	11'2" x 9'6"
Bedroom 3	2.20m x 3.56m	7'3" x 11'8"
Bedroom 4	2.26m x 4.45m	7'5" x 14'7x"
Bathroom	2.13m x 2.17m	7'0" x 7'1"