

SKYLARK

895 SQ FT

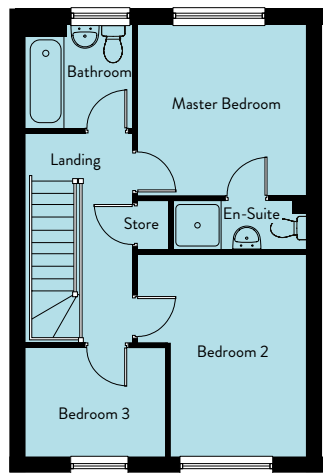
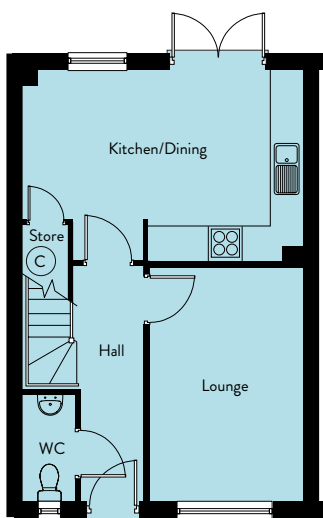

Ground Floor

Lounge	2.81m x 4.33m	9'3" x 14'2"
Kitchen/Dining	5.17m x 3.52m	17'0" x 11'7"
WC	0.95m x 2.00m	3'1" x 6'7"

First Floor

Master Bedroom	3.11m x 3.19m	10'3" x 10'6"
En-Suite	2.48m x 0.90m	8'2" x 2'11"
Bedroom 2	3.11m x 3.72m	10'2" x 12'3"
Bedroom 3	2.57m x 2.00m	8'5" x 6'7"
Bathroom	1.97m x 1.92m	6'5" x 6'4"