

SPARROW

755 SQ FT

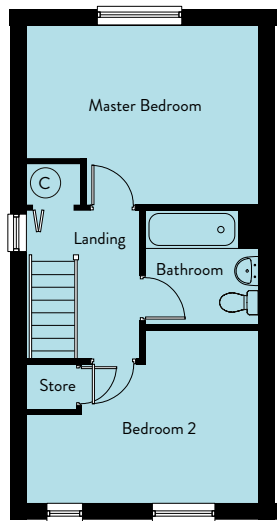
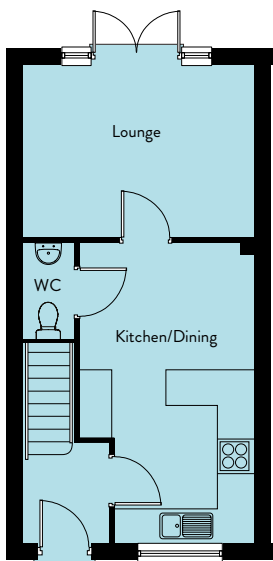

Ground Floor

Lounge	4.11m x 3.09m	13'6" x 10'2"
Kitchen/Dining	3.11m x 5.38m	10'3" x 17'8"
WC	0.91m x 1.72m	3'0" x 5'8"

First Floor

Master Bedroom	4.11m x 3.21m	13'6" x 10'6"
Bedroom 2	4.11m x 3.11m	13'6" x 10'2"
Bathroom	1.96m x 2.06m	6'5" x 6'9"